

# PRE-FINISHED THERMALLY MODIFIED TRIM & MOULDINGS



THERMA  
PRO

## Wood Base Trim

Suited for window and door casings, sills and aprons; wall base and fascia boards.

- Profile: S4S smooth
- Sizes: 1x2", 1x4", 1x6", 1x8"
- Finish: Prefinished CUTTEK® Extreme Clear

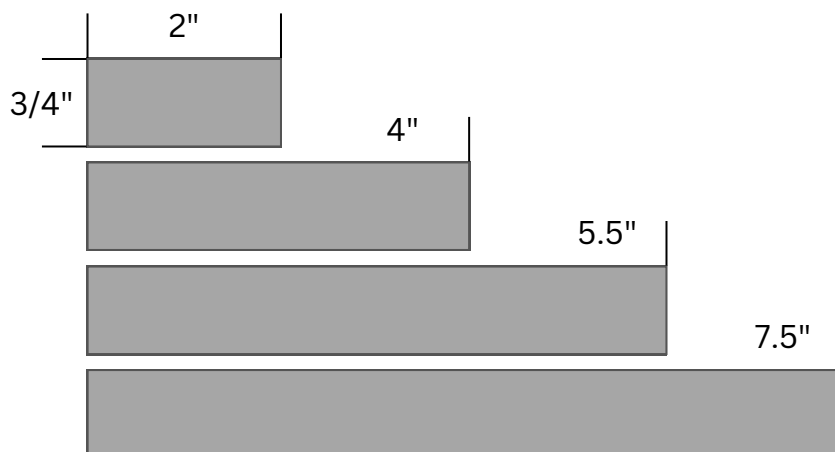

## Finish Mouldings

Quarter Round

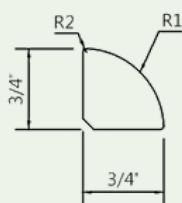

Shoe

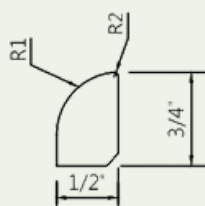

Cove/Scotia

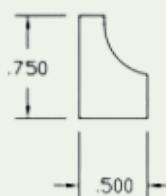

Corner Trim

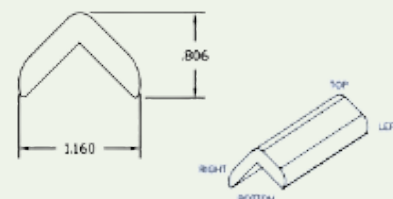

### Species:

S. Yellow Pine

### Manufacturer:

Spartan Forest Products

### Finishing:

CUTTEK® Extreme CD50

- Clear - Standard
- Slows silvering process



(336) 574-0111



sales@spartanforest.com



www.spartanforest.com